



ekostarter.pl

TEL. 509 677 350
TEL. 39 904 12 09
sklep@ekostarter.pl

**ALTERNATORY I ROZRUSZNIKI
DLA PRZEMYSŁU I ROLNICTWA**

DANE TECHNICZNE, ZASTOSOWANIA, WYMIARY



ROZRUSZNIK LAMBORGHINI / TYP L3

Cena :

560,98 zł (netto)

690,00 zł (brutto)

Nr katalogowy : **RIS1254**

Dostępność : **Dostępny**



ROZRUSZNIK

12V, 4.0 kW



ZASTOSOWANIE

LAMBORGHINI - RÓŻNE MODELE

PRZYKŁADOWE ZASTOSOWANIE:

| | Typ | Silnik |
|-------------|--------------|---------------------------------|
| LAMBORGHINI | R3.100 EVO | Deutz 2012 EURO II |
| LAMBORGHINI | R3.85 EVO | Deutz 2012 EURO II |
| LAMBORGHINI | R3.E80100 | TCD2012 L04 2V; 99HP, Tier III |
| LAMBORGHINI | R3.E80110 | TCD2012 L04 2V; 109HP, Tier III |
| LAMBORGHINI | R3.E8085 | TCD2012 L04 2V; 85HP, Tier III |
| LAMBORGHINI | R3.T100 | TCD2012 L04 2V; 4-cyl; 99HP |
| LAMBORGHINI | R3.T85 | TCD2012 L04 2V; 4-cyl; 85HP |
| LAMBORGHINI | R3.TB100 | TCD2012 L04 2V; 99HP, Tier III |
| LAMBORGHINI | R3.TB85 | TCD2012 L04 2V; 85HP, Tier III |
| LAMBORGHINI | R4.100 | TCD2012 L04-2V; 99HP, Tier III |
| LAMBORGHINI | R4.110 | TCD2012 L04 2V; 109HP, Tier III |
| LAMBORGHINI | R4.VRT100 | TCD2012 L04 2V; 99HP, Tier III |
| LAMBORGHINI | R4.VRT110 | TCD2012 L04 2V; 109HP, Tier III |
| LAMBORGHINI | R6.100 | Deutz EURO III/II; 100HP |
| LAMBORGHINI | R6.110 | Deutz EURO III/II; 110HP |
| LAMBORGHINI | R6.115 | TCD 2012 L06-2V; 6-cyl; 130kW |
| LAMBORGHINI | R6.120 | Deutz 2012; 120HP; Tier II |
| LAMBORGHINI | R6.125 | TCD2012 L04-2V; 130kW, Tier III |
| LAMBORGHINI | R6.130 | TCD2012 L6..; 130HP, Tier III |
| LAMBORGHINI | R6.140 | TCD2012 L6.. 140HP, Tier II |
| LAMBORGHINI | R6.160 | TCD2012 L6.. 160HP, Tier II |
| LAMBORGHINI | R6.175 | TCD2012 L6.. 175HP, Tier III |
| LAMBORGHINI | R6.185 | TCD2012 L6.. 185HP, Tier III |
| LAMBORGHINI | R6.VRT.165.7 | TCD2013L06; 164HP, Tier II/III |
| LAMBORGHINI | R6.VRT.165.7 | TCD2013L06; 174HP, Tier II/III |
| LAMBORGHINI | R6. T4i150 | TCD6,1 L6; 149HP; Tier IIIb |
| LAMBORGHINI | R6. T4i150.4 | TCD4,1 L4; 149HP, Tier 4 |
| LAMBORGHINI | R6. T4i160 | TCD6,1 L6; 161HP; Tier IIIb |
| LAMBORGHINI | R6. T4i160.4 | TCD4,1 L4; 166HP, Tier 4 |
| LAMBORGHINI | R6. T4i180 | TCD6,1 L6; 175HP; Tier IIIb |
| LAMBORGHINI | R6. T4i 190 | TCD6,1 L6; 193HP; Tier IIIb |
| LAMBORGHINI | R7.210 | Deutz TDC2013 L06 2V DCR |
| LAMBORGHINI | R7.220 | TCD2013 L06; 220HP, Tier III |
| LAMBORGHINI | R8.230 | Deutz Common Rail 2013 EURO 3 |
| LAMBORGHINI | R8.270 | Deutz Common Rail 2013 EURO 3 |

ISKRA: 11.132.256; AZF4343; 11.132.137; AZF4309; 11.131.769; AZF4197;
11.131.754; AZF4194; 11.131.620; AZF4179;

KHD / DEUTZ: 0118 0928; 0118 1976; 0118 2233; 0118 2925; 0118 3120; 0118 3235; 0118 3677; 0118 3712;

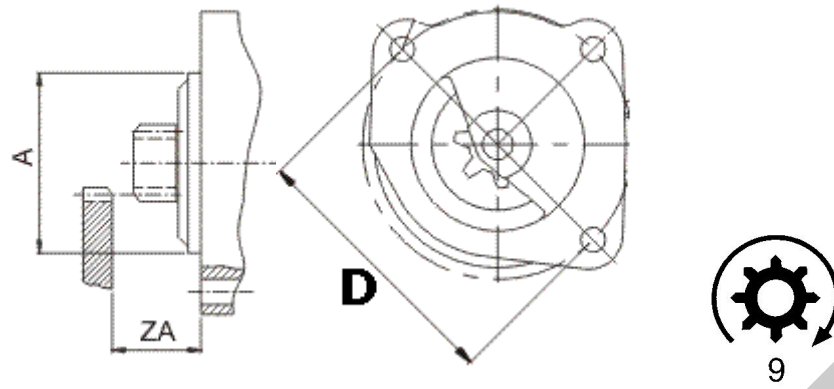

| | wymiary |
|----|---------|
| A | 89 mm |
| D | 127 mm |
| ZA | 31 mm |

ekostarter.pl